

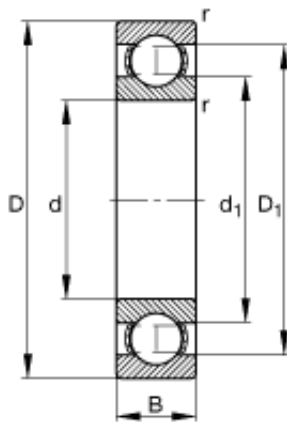

BEARING CORP.OF CANADA LTD.



60 mm x 95 mm x 18 mm FAG 6012 A/C Compressor clutches Bearing

Bearing No. 6012

6012 Bearing 2D drawings and 3D CAD models

Size	60x95x18 mm
Bore Diameter	60 mm
Outer Diameter	95 mm
Width	18 mm
d	60 mm
D	95 mm
B	18 mm
D ₁	83,9 mm
D _{a max}	89 mm
d ₁	71,3 mm
d _{a min}	66 mm
r _{a max}	1 mm
r _{min}	1,1 mm
m	0,419 kg / Weight
C _r	31500 N / Dynamic load rating (radial)
C _{0r}	23200 N / Static load rating (radial)
n _G	10100 1/min / Limiting speed
n _B	7600 1/min / Reference speed
C _{ur}	1190 N / Fatigue limit load, radial